

Item	Quantity	Unit	Unit Cost	Unit Total	Sub-total
<b>TREES</b>					
Large trees (6" cal.)	1	EA	\$3,400.00	\$3,400.00	
Medium Trees (4-5" cal.)	12	EA	\$1,500.00	\$18,000.00	
Small Trees (Clump & 2-3" cal.)	15	EA	\$750.00	\$11,250.00	
<i>Trees Subtotal</i>					\$32,650.00
<b>RAIN GARDEN</b>					
Perennials	344	Sq. ft.	\$18.00	\$6,192.00	
Shrubs	40	EA	\$35.00	\$1,400.00	
<i>Rain Garden Subtotal</i>					\$7,592.00
<b>PERENNIALS &amp; GROUNDCOVER</b>					
Around outside of rain garden	500	Sq. ft.	\$18.00	\$9,000.00	
by parking	200	Sq. ft.	\$18.00	\$3,600.00	
by stone dust	200	Sq. ft.	\$18.00	\$3,600.00	
<i>Perennial Subtotal</i>					\$16,200.00
<b>METAL EDGING</b>					
Around Stone dust court	425	LF	\$10.00	\$4,250.00	
<i>Edging Subtotal</i>					\$4,250.00
<b>SEED MIX</b>					
Seed lawn	12400	Sq. ft.	\$0.15	\$1,860.00	
Conservation mix	8960	Sq. ft.	\$0.20	\$1,792.00	
<i>Seed Subtotal</i>					\$3,652.00
<b>SITE WORK</b>					
See individual phase for breakdown		Lump		\$67,500	
<i>Sitework Subtotal</i>					\$67,500.00
<b>HARDSCAPE</b>					
C.I.P. concrete paving at terrace	27	Cu. Yds.	\$100.00	\$2,700.00	
Permeable Pavers	1944	Sq. ft.	\$20.00	\$38,880.00	
*Kebony (wood) & metal cantilevered deck	192	Sq. ft.	\$100.00	\$19,200.00	
*Kebony (wood) boardwalk	480	Sq. ft.	\$30.00	\$14,400.00	
C.I.P. concrete paving at bridge	18	Cu. Yds.	\$100.00	\$1,800.00	
Permeable C.I.P. concrete	3081	Sq. ft.	\$8.00	\$24,648.00	
Stonedust	426	Sq. ft.	\$6.00	\$2,556.00	
<i>Hardscape Subtotal</i>					\$104,184.00
<b>CIP CONCRETE WALLS</b>					
near rain garden 1.5 x 37 x6.5	13	Cu. Yds.	\$400	\$5,200.00	
south of site 2 x 60 x 8	35	Cu. Yds.	\$400	\$14,000.00	
along river just north of bridge 1.5 x 120 x 11	73	Cu. Yds.	\$400	\$29,200.00	
along river north of boardwalk 1.5 x 108 x10	60	Cu.Yds	\$400	\$24,000.00	
<i>CIP Concrete Wall Subtotal</i>					\$72,400.00
<b>SITE FURNISHINGS</b>					
Custom conc. & wood benches at terrace	3	EA	\$1,500	\$4,500.00	
Metal & Wood benches	3	EA	\$2,000	\$6,000.00	
<i>Furnishings Subtotal</i>					\$10,500.00
<b>LIGHTING</b>					
Pole lighting	14	EA	\$2,000	\$28,000.00	
Bollards	5	EA	\$2,200	\$11,000.00	
<i>Lighting Subtotal</i>					\$39,000.00
<b>Solar Array</b>					
PV Panels		Lump		\$35,000.00	
Mounting					
Controls					
Digital output display					
<i>Lighting Subtotal</i>					\$35,000.00
<b>SIGNAGE</b>					
		Lump		\$5,000.00	
<i>Signage Subtotal</i>					\$5,000.00
<b>SUBTOTAL</b>					\$397,928.00
15% Contingency					\$59,689.20
<b>GRAND TOTAL</b>					\$457,617.20

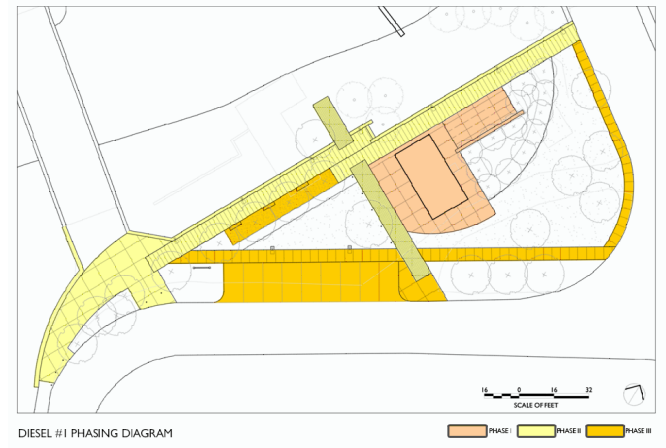

Items not included in estimate
Shed demolition and removal
Architectural improvements
-New Walls
-New Greenroof structure
-New Windows & Doors
-Interior Lighting
Security cameras
Relocation of Utilities
Model Windmill
Remediation work and site development may overlap. Should coordinate all site work and paving estimates with remediation estimates.
Wood & Metal Pergola on Diesel Building

**PHASE I**

**Diesel Eco Energy Park**

H. Keith Wagner Partnership

**Probable Estimate of Phase I Landscape Costs**

March '10

Item	Quantity	Unit	Unit Cost	Unit Total	Sub-total
<b>SITE WORK</b>	Lump			\$10,000	
Top Soil for areas to be seeded					
Aggregate Materials					
Subbase for concrete paving at terrace around building					
Local Grading					
<i>Sitework Subtotal</i>					\$10,000.00
<b>HARDSCAPE</b>					
C.I.P. concrete paving at terrace @ building	27	Cu. Yds.	\$100.00	\$2,700.00	
<i>Hardscape Subtotal</i>					\$2,700.00
<b>CIP CONCRETE WALLS</b>					
Near (future) rain garden 1.5 x 37 x6.5	13	Cu. Yds.	\$400	\$5,200.00	
					\$5,200.00
<b>SEED MIX</b>					
Seed lawn	6200	Sq. ft.	\$0.15	\$930.00	
<i>Seed Subtotal</i>					\$930.00
<b>SUB TOTAL</b>					\$18,830.00
15% Contingency					\$2,824.50
<b>PHASE I TOTAL</b>					\$21,654.50

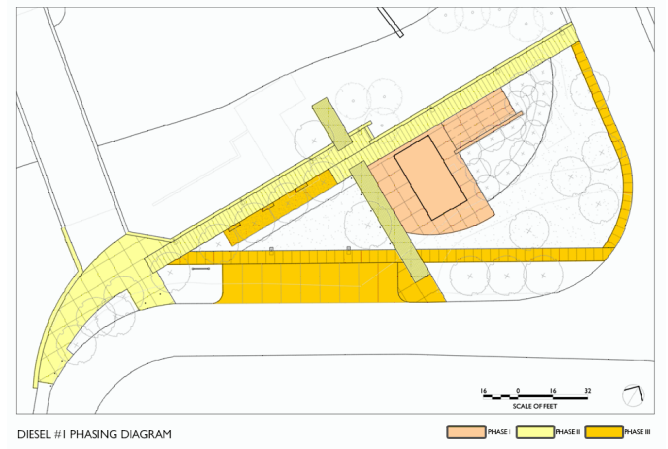

**PHASE II**

**Diesel Eco-Energy Park**

H. Keith Wagner Partnership

**Probable Estimate of Phase II Landscape Costs**

March '10

Item	Quantity	Unit	Unit Cost	Unit Total	Sub-total
<b>SEED MIX</b>					
Conservation mix	8960	Sq. ft.	\$0.20	\$1,792.00	
<i>Seed Subtotal</i>					\$1,792.00
<b>SITE WORK</b>					
Top Soil for distrubed areas to be seeded	Lump			\$42,500	
Aggregate Materials					
Excavation for Walls					
Subbase for permeable pavers					
Grading					
Slope stabilization					
Fill material					
<i>Sitework Subtotal</i>					\$42,500.00
<b>HARDSCAPE</b>					
C.I.P. concrete paving at bridge	18	Cu. Yds.	\$100.00	\$1,800.00	
Permeable Pavers	1944	Sq. ft.	\$20.00	\$38,880.00	
*Kebony (wood) & metal cantilevered deck	192	Sq. ft.	\$100.00	\$19,200.00	
*Kebony (wood) boardwalk	480	Sq. ft.	\$30.00	\$14,400.00	
<i>Hardscape Subtotal</i>					\$74,280.00
<b>CIP CONCRETE WALLS</b>					
south of site 2 x 60 x 8	35	Cu. Yds.	\$400	\$14,000.00	
along river just north of bridge 1.5 x 120 x 11	73	Cu. Yds.	\$400	\$29,200.00	
along river north of boardwalk 1.5 x 108 x 10	60	Cu.Yds	\$400	\$24,000.00	
<i>Hardscape Subtotal</i>					\$67,200.00
<b>SUBTOTAL</b>					<b>\$185,772.00</b>
15% Contingency					\$27,865.80
<b>PHASE II TOTAL</b>					<b>\$213,637.80</b>



LANDSCAPE ARCHITECTS  
 H. KEITH WAGNER | PARTNERSHIP  
 7 Marble Avenue, Burlington VT 05401 T 802.864.0010 F 802.864.4367 hkw-p.com

**cost estimate 04.2010**

cost estimate based on site master plan broken down into 3 phases

**PHASE III**

Item	Quantity	Unit	Unit Cost	Unit Total	Sub-total
<b>TREES</b>					
Large trees (6" cal.)	1	EA	\$3,400.00	\$3,400.00	
Medium Trees (4-5" cal.)	12	EA	\$1,500.00	\$18,000.00	
Small Trees (Clump & 2-3" cal.)	15	EA	\$750.00	\$11,250.00	
<i>Trees Subtotal</i>					\$32,650.00
<b>RAIN GARDEN</b>					
Perennials	344	Sq. ft.	\$18.00	\$6,192.00	
Shrubs	40	EA	\$35.00	\$1,400.00	
<i>Rain Garden Subtotal</i>					\$7,592.00
<b>PERENNIALS &amp; GROUNDCOVER</b>					
Around outside of rain garden	500	Sq. ft.	\$18.00	\$9,000.00	
by parking	200	Sq. ft.	\$18.00	\$3,600.00	
by stone dust	200	Sq. ft.	\$18.00	\$3,600.00	
<i>Perennial Subtotal</i>					\$16,200.00
<b>Metal Edging</b>					
Around Stone dust court	425	LF	\$10.00	\$4,250.00	
<i>Edging Subtotal</i>					\$4,250.00
<b>SEED MIX</b>					
Reseed all lawn areas	6200	Sq. ft.	\$0.15	\$930.00	
<i>Seed Subtotal</i>					\$930.00
<b>SITE WORK</b>					
Top Soil for disturbed areas to be reseeded	Lump			\$15,000	
Aggregate Materials					
Excavation for Rain Garden					
Excavation for Landscaping					
Soil Prep for Rain Garden					
Duffy Hill Road Repair					
Subbase for permeable paving					
Subbase for stonedust					
Grading					
Fill material					
<i>Sitework Subtotal</i>					\$15,000.00
<b>HARDSCAPE</b>					
Permeable C.I.P. concrete	3081	Sq. ft.	\$8.00	\$24,648.00	
Stonedust	426	Sq. ft.	\$6.00	\$2,556.00	
<i>Hardscape Subtotal</i>					\$27,204.00
<b>SITE FURNISHINGS</b>					
Custom conc. & wood benches at terrace	3	EA	\$1,500	\$4,500.00	
Metal & Wood benches	3	EA	\$2,000	\$6,000.00	
<i>Furnishings Subtotal</i>					\$10,500.00
<b>LIGHTING</b>					
Pole lighting	14	EA	\$2,000	\$28,000.00	
Bollards	5	EA	\$2,200	\$11,000.00	
<i>Lighting Subtotal</i>					\$39,000.00
<b>Solar Array</b>					
PV Panels	Lump			\$35,000.00	
Mounting					
Controls					
Digital output display					
<i>Lighting Subtotal</i>					\$35,000.00
<b>SIGNAGE</b>					
	Lump			\$5,000.00	
<i>Signage Subtotal</i>					\$5,000.00
<b>SUBTOTAL</b>					<b>\$193,326.00</b>
15% Contingency					\$28,998.90
<b>PHASE III TOTAL</b>					<b>\$222,324.90</b>

