

- Legend**
- 7 Grid Number
 - Grid
 - Lake, Pond or River
 - River, Stream or Brook
 - Interstate Highway
 - Federal Highway
 - State Highway
 - Class 1 Town Highway
 - Class 2 Town Highway
 - Class 3 Town Highway
 - Class 4 Town Highway
 - Legal Trail
 - Private Road
 - Town Boundary

ROAD NAME	GRID	ROAD NAME	GRID	ROAD NAME	GRID	ROAD NAME	GRID	ROAD NAME	GRID
Abenaki Acres	47	Covey Dr	18	Hilltop Acres	33	Middle Rd	16, 18, 24, 25, 28, 30	Swanton Hill Rd	41, 42
Academy St	46	Daprato Memorial Dr	17, 45	Hodgdon Dr	19	Missisquoi St	19	Sweet Hollow Rd	33, 39
Aljon St	17	Dawns Wy	35	Hog Island Rd	9, 13	Moreau Dr	15	Tabor Rd	4, 10, 9
Ally Dr	18	Demers Dr	20, 25, 47	Homestead Acres Pk	38	Mountain View Dr	36	Tanner Memorial Dr	45
Anderson Ln	30	Depot St	18	Homestead Rd	9	New St	45, 46	Taylor Dr	17
Andy Av	19	Dewey St	18	Howard St	18	Nokes Rd	9, 13	Taylor Dr Ext	17
Anna Dr	15	Donaldson Rd	21, 26	Janes Rd	18	North River St	1, 4, 6, 11, 12, 17, 18	Thibault Pkwy	17
Arrowhead Dr	13	Dorian Dr	39	Jayview Ln	9	North St	17, 18	Thibault St	45
Assid Dr	25	Dunbar Ln	26	Jerry Mill Ln	37, 38	Olive St	18	Thunderbird Dr	16, 19
Austin Dr	37	Dunning St	45	Jewett St	20, 47	Pennell Rd	31	Tilley Dr	9
Babbie Blvd	17	Earlita Ln	37	John Dr	17	Pickle Pt Rd	3	Torrie Dr	19
Bachand Rd	35	Elm St	19, 45	Jonerain Dr	17, 18	Pierce Rd	3	Tremblay Rd	41
Barney Ln	25, 26	Endeavors Ln	21	Jones Ct	17	Pine St	19, 45, 46	Turkey Ter	9
Beebe Rd	25	Evelyn Ln	17	Jordan Ln	38	Platt St	46, 47	Tyler's Way	4, 5
Begnoche Dr	26	Fadden Rd	2	Kane Av	45	Pond Rd	39	Upper Ferris St	20, 25, 47
Bigelow Dr	16	Farrar St	46	Kaye Pt Rd	41	Precision Ln	19	Viens Rd	37, 39
Blake St	20, 47	Ferris St	47	Kellogg Rd	36	Queen's Ct	7	Village St	18
Bosworth St	45	Furman Pl	46	King St	45	Reservoir Rd	21, 26	Waugh Farm Rd	19, 21
Broadway St	45, 46	Gagne Dr	21	Lafar St	19	Reynolds Rd	42	Webster Ter	45
Brooklyn	17, 18	Gallup Ct	18	Lake St	14, 15, 16, 18	Ridgewood Ct	35	Wheeler Round	17
Brown Av	17, 45	Garnach Ln	37, 38	Lakewood Dr	7, 8	River Ln	18	Winters Ct	17
Bushey Rd	32, 33, 37, 38	Gatan Dr	15	Lakewood Dr	4, 5, 7, 8, 9	Robin Hood Dr	19	Woods Hill Rd	26, 27
Bushey St	19, 47	Gauthier Dr	35	Lantern Ln	35	Rocky Ridge Rd	41	Yandow Rd	2
Butternut Ln	26	Charles St	17	Laroe St	47	Russell Rd	33	York St	46
Callan Dr	37	Church Rd	1, 2, 3, 4, 6	Lasnier Rd	14, 15	Rustic Walk	21, 26		
Campbell Bay Rd	2, 3, 6	Comstock Rd	34, 36	Lavoie Av	17	Ruth's Circle	39		
Canada St	18, 45, 46	Cook Rd	27	Lebel Dr	41	Samhannah Dr	36		
Cedar Ledge Est	31, 35	Cota Dr	25	Leduc Dr	19	Sandy Point Rd	1, 4		
Ceres Cir	37	Country Acres	20	Leffly Ln	47	Scott St	18		
Champlain St	8, 9	Country Club Est	36	Leo Drive	3	Second St	38, 40, 41		
Charles St	17	Country Ln	33	Liberty St	45, 46	Sheldon Rd	33, 39, 40, 41		
Church Rd	1, 2, 3, 4, 6	Country Rd	31	Lime Kiln Rd	35	Shetland Ln	25		
Church St	18, 46	Country Rd	25, 31, 34	Linda Av	17, 45	Sholan Rd	40, 41		
Comstock Rd	34, 36	Covey Dr	18	Lord Rd	30	Short St	19, 46		
Cook Rd	27	Daprato Memorial Dr	17, 45	Madison Dr	25	South River St	18, 20, 25		
Cota Dr	25	Dawns Wy	35	Malcolm St	18	Spring St	17, 45		
Country Acres	20	Dewey St	18	Maple	9	St Albans Rd	20, 25, 26, 31, 32, 35, 36, 37		
Country Club Est	36	Dunbar Ln	26	Maple Grove Est	35	Stanley Ln	37		
Country Ln	33	Dunning St	45	Maple Ridge Est	26	Stearns Ct	17		
County Rd	25, 31, 34	Earlita Ln	37	Maquam Shore Rd	15, 22, 23, 28, 29	Sugar Maple Dr	35, 36		
		Elm St	19, 45	Meadow Ln	47	Sunset Harbor Rd	2		
		Endeavors Ln	21	Merchants Row	18	Sunset Ter	35, 36		

Vermont Coordinate System
 Transverse Mercator, NAD 83.
 For planning purposes only.
 Prepared by:
 Northwest Regional
 Planning Commission
 155 Lake Street
 St. Albans, VT 05478
 802.524.5958
 www.nrpvt.com
 February, 2011.

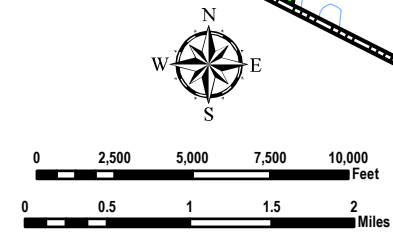

TOWN & VILLAGE OF SWANTON